



FLATBOX WALLMOUNT CABINETS 19" FLATBOX



- ▶ Flatpack for reduce space during storage and transport
- ▶ Vertical organised packaging to easier picking of the parts during assembly and prevent any damage during transport
- ▶ Packaging with handles



MAIN FEATURES

- ▶ Type: sides access
- ▶ Design: steel, assembly by screws
- ▶ 19" mounting profiles: 2 adjustable in depth 19" mounting profiles
- ▶ Front door: reversible security front glass door with side profiles, can be opened up to 180°, locked by using key lock (N°333)
- ▶ Side panels: removable for easier access, locked by using key lock (N°333)
- ▶ Cables entries: on the top and the bottom
- ▶ Ventilation: ventilated (fan unit available in option)
- ▶ Width: 600 mm
- ▶ Depth: 500 or 600 mm
- ▶ Load capacity: 50 kg
- ▶ Earthing kit included

- ▶ Easy access with removable front door and sides panels
- ▶ Assembly with only one tool (included)

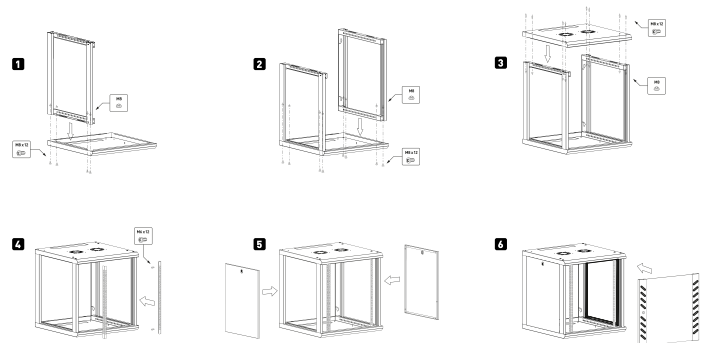

	DEPTH 500 MM	DEPTH 600 MM
6 U	GGM C0F6U5FPN	-
9 U	GGM C0F9U5FPN	GGM C0F9U6FPN
12 U	GGM C0F12U5FPN	GGM C0F12U6FPN
15 U	GGM C0F15U5FPN	GGM C0F15U6FPN
18 U	GGM C0F18U5FPN	GGM C0F18U6FPN
21 U	GGM C0F21U5FPN	GGM C0F21U6FPN

ACCESSORIES

